



EXCLUSIVE AUTOMOTIVE PRODUCTS

**AUTOTECNICA SEAT FITTING INSTRUCTION
 TO SUIT NISSAN PATROL GU Y61**

PLEASE READ THE INSTRUCTION IN FULL BEFORE FITTING AUTOTECNICA SEAT/SEATS TO THE VEHICLE

1. Park the vehicle in a suitable position and ensure the hand brake is on. Remove seats/seats from the vehicle and retain bolts to be used when refitting the new seat. Remove seat belt stalk from the seat to be used with the new seat slider assembly.

See below contains supplied.

Photo A. Adaptors 2 pc kit, 1 Stabilizer bar, 3 M8 bolts 35mm, 1 M8 bolt 20mm bolt, 8 washers, and 4 nuts
 Photo B. Seat slider assembly. 1x seat belt bracket, 4x 42mm M8 bolts, 1x25mm seat belt bolt with washers and nuts. 2x10mm washes (green spot), 1x5mm (white spot), 4 x flat, and 4 x spring washers.

Photo A

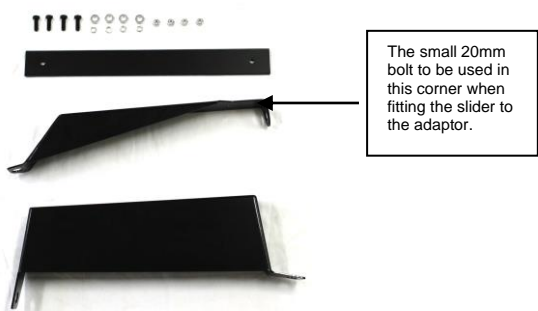

Photo B



2. Rest the new seat upside down on top of a bench and place the 2 x10mm spaces on top of a green spot of the seat mounting holes. Place the seat belt bracket with the extended angle plate pointing up on the seat and the 5mm spacer on top of the seat belt connecting the bar white spot. Photo "C1".

Ensure to attach the seat belt stalk removed to the seat bracket with the 25mm bolt with the nut and washes supplied. Photo "C2". Place the slider assembly on the seat. See Photo C3

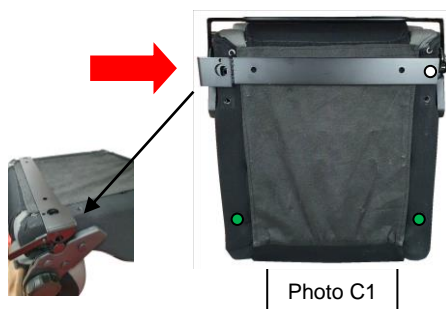

Photo C1



Photo C2



Photo C3

- 3 Note: Use the 4x42mm bolts to attach the slider assembly onto the appropriate seat mounting holes. To adjust the slider frontward and backward movements press onto the slider adjusting lever. See Photo D1. Ensure that the sliders are correctly positioned and alighted before securing and inserting the main adjusting lever. See Photo D2



Slider adjusting lever

Photo D1

42mm bolt

Photo D2



4. Position the adaptors onto the seat "high adaptor to the door side of the vehicle" by using the supplied 35mm bolts/washes on each corner of the adaptors. See Photo "E". Attach the lower adaptor to the inner part of the seat. Use the 35mm bolt to the rear of the adaptor and the 25mm bolt to the front of the adaptor. Ensure that the stabilizer bar is fitted to the rear of the seat See Photo F. Do not tighten the bolts at this stage as the adaptors need to be positioned correctly.

The adaptors have 4 positioning slotted holes. Before bolting the adaptors to the seat slider assembly, please ensure that the adaptors are fully positioned to the outer of the slotted holes of the adaptors. When fitted to GU models, wider seats in the Autotecnica range will be very close to the centre console. In order to gain maximum spacing, we recommend the above be followed.

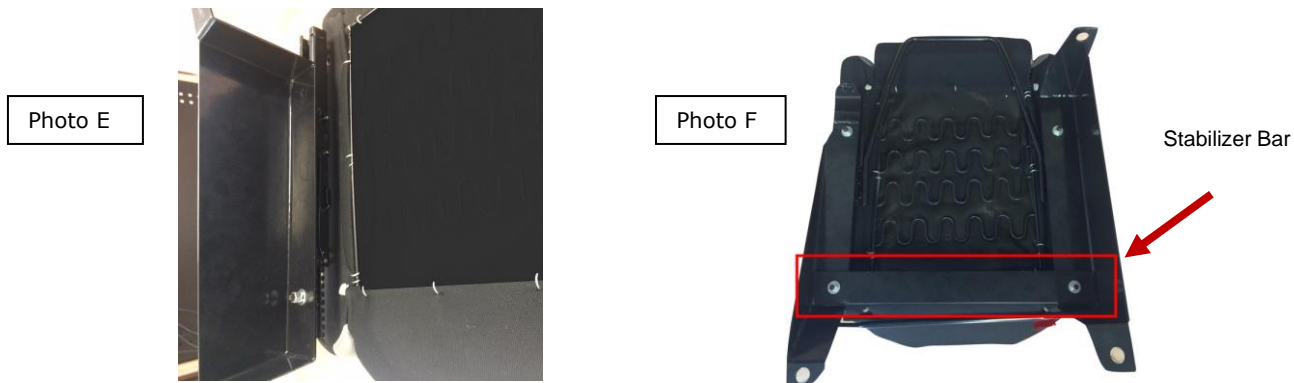

5. When the assembly is completed, double-check that all bolts and nuts are secure. Place the seat into the vehicle. Align the front and rear adaptors to the vehicle floor mounting holes. Use the 4 original bolts to correctly attach the seat to the vehicle floor and tension.



Photo of the seat on to vehicle's passenger side.

Image used for illustration purposes only

Note: The Autotecnica seats are ADR Approved.

We recommend however that the seat conversion is checked by an accredited engineer after fitting the seat or seats to the vehicle.